

For product support please call
01235 546810

BM3300

vtech® Safe & Sound® 2.8" Colour Video Baby Monitor



vtech® User's manual

Congratulations

on purchasing your new VTech product. Before using this product, please read **Important safety instructions**.

This manual has all the feature operations and troubleshooting necessary to install and operate your new VTech product. Please review this manual thoroughly to ensure proper installation and operation of this innovative and feature rich VTech product.

What's in the box

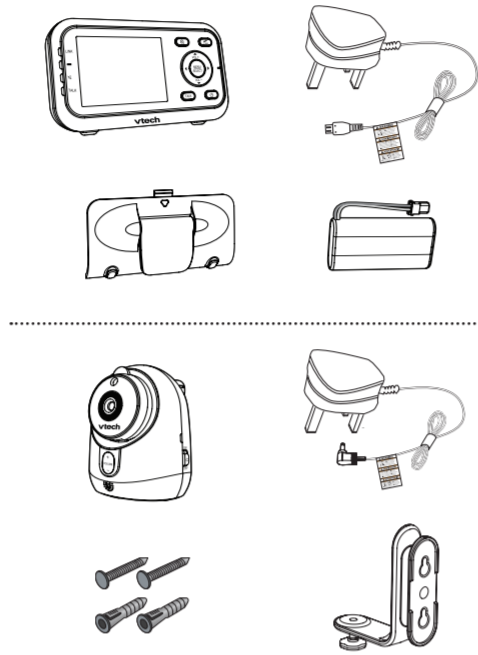

Install the battery

The parent unit runs on a rechargeable battery or AC power. To continuously monitor your baby, make sure you use both battery and AC power at the same time. With the battery alone, the parent unit can cordlessly run for a short time only.

NOTES

- Use only the battery supplied with this product.
- The operating time for using the rechargeable battery is short. If you want to monitor your baby for a long time, we recommend you connect the parent unit to AC power.
- If the parent unit will not be used for a long time, disconnect and remove the battery to prevent possible leakage.

Install the battery as shown below.

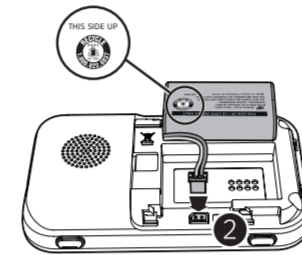
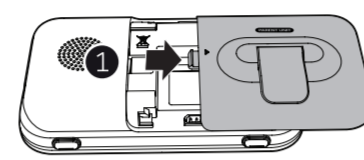

NOTE

- Make sure the label **THIS SIDE UP** is facing up while inserting the battery.

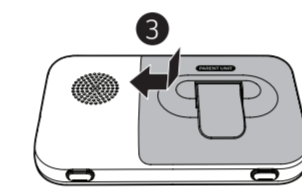

Replace the battery

To replace the battery, pull out the battery compartment cover, and then lift up the battery. Follow the steps above to install the new battery.

Connect and charge the battery

NOTES

- Use only the power adaptors supplied with this product.
- The power adaptors are intended to be correctly oriented in a vertical or floor mount position. The prongs are not designed to hold the plug in place if they are plugged into a ceiling, under-the-table or cabinet outlet.
- Make sure the parent unit, the baby unit and the power adaptor cords are out of the reach of children.

Connect the baby monitor

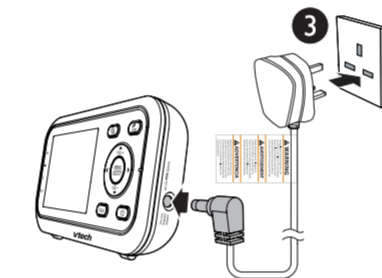
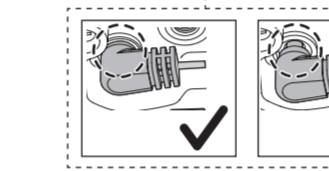
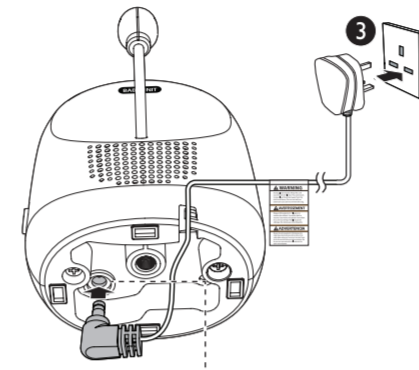

Charge the parent unit battery

When you have connected the parent unit and installed its battery for the first time or after power outage, the parent unit will power on automatically. The battery icon indicates the battery status (see the following table).

NOTES

- The parent unit battery is fully charged after 11 hours of continuous charging.
- It takes longer to charge the battery when the parent unit is turned on. To shorten the charging time, turn the parent unit off while charging.
- The standby time varies depending on the volume level you set, your actual use and the age of the battery.

Battery indicators	Battery status	Action
The battery icon is off and displays.	No battery is installed but operates using AC power, or the battery has been installed incorrectly.	Install the parent unit battery. Charge without interruption (at least 30 minutes).
The screen displays Battery low at Parent Unit and . The light flashes.	The battery has very little charge and may be used for only a short time.	Charge without interruption (about 30 minutes).
The battery icon becomes solid .	The battery is fully charged.	To keep the battery charged, connect it to AC power when not in use.

Before use

NOTE

- This baby monitor is intended as an aid. It is not a substitute for proper adult supervision, and should not be used as such.

Test your baby monitor

You should test the baby monitor before initial use, and at regular times thereafter.

CAUTION

- For hearing protection, make sure the parent unit is more than 1 metre (3 feet) away from the baby unit. If you hear any high-pitched noise, move the parent unit further away until the noise stops. You can also press **VOL-** on the parent unit to lower or mute the noise.

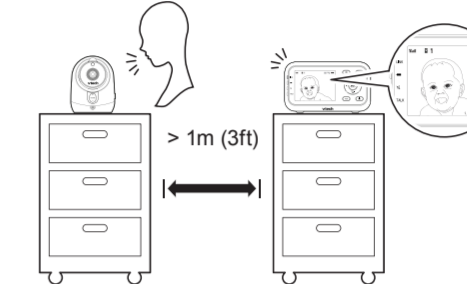

- Make sure your baby unit and parent unit are on.
- The parent unit displays images from the baby unit.
 - Speak towards the microphone of the baby unit. You will hear the sound at the parent unit.

NOTE

- When the parent unit displays **No link to Camera**, and the **LINK** LED light flash, move the parent unit closer to the baby unit (observe the minimum distance of 1 metre/ 3 feet). You can also check if the baby monitor is connected to a live power socket and switched on.

TIP

- Increase the speaker volume of the parent unit if you cannot hear the sounds transmitted from the baby unit.

Positioning the baby monitor

CAUTION

- Keep the baby unit out of the reach of your baby. Never place or mount the baby unit inside the baby's cot or playpen.

NOTE

- To avoid interference from other electronic devices, place your baby monitor far away from devices such as wireless routers, microwaves, mobile phones and computers.

- Place the baby unit more than 1 metre (3 feet) away from your baby.

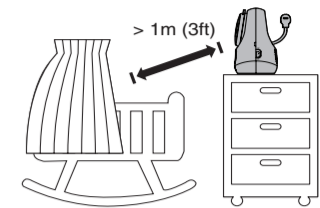

- Place the parent unit more than 1 metre (3 feet) away from the baby unit.

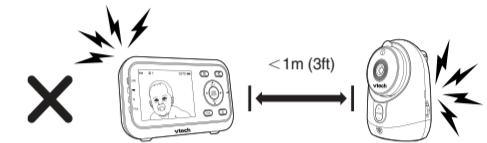
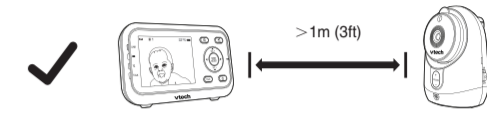

- Flip down the camera on the baby unit to adjust the angle according to your preference.



CAUTION

- The default volume of your parent unit is level 4. If you experience high-pitched screaming noise from your baby monitor while positioning:
 - Make sure your baby unit and parent unit are more than 1 metre (3 feet) apart, OR
 - Turn down the volume of your parent unit.

Operating range

The operating range of the baby monitor is up to 300 metres (1,000 feet) outdoors or 50 metres (160 feet) indoors. The actual operating range may vary depending on the environmental conditions and other interferences such as walls, doors and other obstructions.

Overview

Baby unit overview

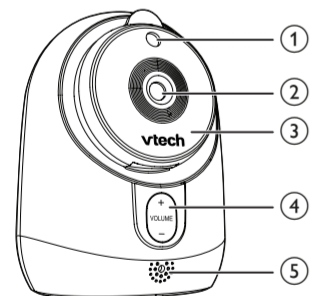

1	Light sensor
2	Camera
3	Infrared LEDs
4	-/VOLUME/+ <ul style="list-style-type: none"> Press to adjust the speaker volume. It determines the talkback volume transmitted from your parent unit.
5	Microphone
6	ON/OFF LED light <ul style="list-style-type: none"> On when the baby unit is turned on and is paired to the parent unit. Flashes when the baby unit is not being viewed; or when the link to the parent unit is lost.
7	ON/OFF switch <ul style="list-style-type: none"> Slide to turn the baby unit on or off.
8	Temperature sensor
9	Speaker
10	Threaded socket <ul style="list-style-type: none"> For wall mount installation use.
11	Power Jack
12	PAIR <ul style="list-style-type: none"> Your baby unit and parent unit provided are already paired.

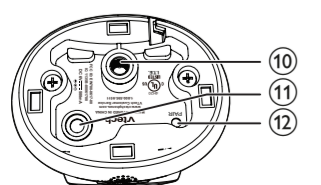
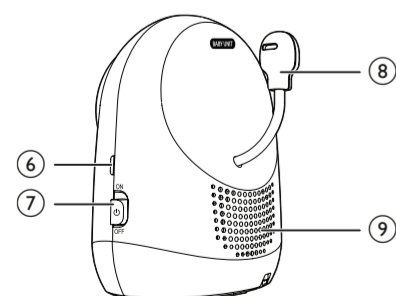

Parent unit overview

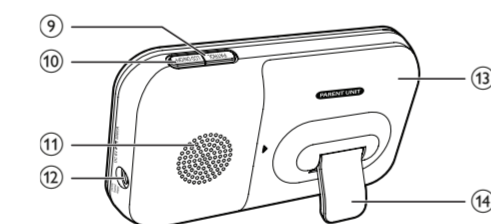
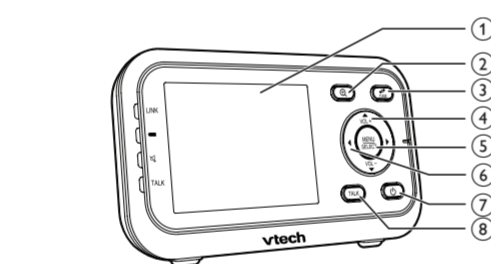

1	LCD display
2	Zoom <ul style="list-style-type: none"> Press to zoom in or out while viewing images.
3	CAM
4	VOL+ / VOL- <ul style="list-style-type: none"> Turn the volume up when the speaker is on. While in a menu, press to scroll up, or to enter an item's sub-menu. While zooming, press and hold to move the zoomed image up. Turn the volume down when the speaker is on. While in a menu, press to scroll down. While zooming, press and hold to move the zoomed image down.
5	MENU/SELECT <ul style="list-style-type: none"> Press to enter/exit the menu. While in a sub-menu, press to choose an item, or save a setting.

6	<ul style="list-style-type: none"> While in a menu, press to choose the next item on the left, or enter into the submenu, if any. While zooming, press and hold to move the zoomed image to the left. While in a menu, press to choose the next item on the right, or return to the main menu while in submenu. While zooming, press and hold to move the zoomed image to the right.
7	On/off <ul style="list-style-type: none"> Press and hold to power on. Press and hold again to power off.
8	TALK <ul style="list-style-type: none"> Press and hold to talk to the baby unit.
9	PATROL
10	LCD ON/OFF <ul style="list-style-type: none"> Press to turn the LCD screen on or off.
11	Speaker
12	Power jack
13	Battery compartment cover
14	Stand

Parent unit lights

LINK	On when the parent unit is linked to the baby unit. Flashes quickly when the link to the baby unit is nearly lost.
	On when the parent unit is connected to AC power, or the battery is charging. Flashes when the parent unit battery is low and needs charging. Off when the parent unit is disconnected from AC power.
TALK	On when the parent unit is talking to the baby unit.
	On when the speaker volume of the parent unit is turned off.

Parent unit status icons

	Connection status <ul style="list-style-type: none"> or displays when strong signal strength is detected between the baby unit and the parent unit. or displays when moderate or low signal strength is detected between the baby unit and the parent unit. displays when the link between the baby unit and the parent unit is lost.
	Zoom <ul style="list-style-type: none"> Displays when the camera at the baby unit has zoomed in.
	Night vision <ul style="list-style-type: none"> Displays when the baby unit has activated the night vision feature.
	Lullaby <ul style="list-style-type: none"> Displays when a lullaby is playing.
	Talkback <ul style="list-style-type: none"> Displays when talking back to the baby unit from the parent unit.

	6-level sound indicator <ul style="list-style-type: none"> Displays the sound level when there is sound transmitted from the baby unit. (1 to 2 bars) indicates low sound level detected by the baby unit. (3 to 4 bars) indicates moderate sound level detected by the baby unit. (5 to 6 bars) indicates high sound level detected by the baby unit (e.g. baby crying loudly).
	Mute alert <ul style="list-style-type: none"> Displays when the parent unit speaker volume is set to off.
	Real-time temperature <ul style="list-style-type: none"> Displays the real-time temperature detected by the baby unit in Fahrenheit (°F) or Celsius (°C) (e.g. 57°F or 14°C).
	Battery status <ul style="list-style-type: none"> animates when the battery is charging. displays solid when the battery is fully charged. displays when the battery is low and needs charging.
	AC power without battery <ul style="list-style-type: none"> Displays when the parent unit is connected to AC power without the battery.
	Speaker volume <ul style="list-style-type: none"> Displays the parent unit speaker volume level while adjusting.

Parent unit main menu icons

	Brightness <ul style="list-style-type: none"> You can change the brightness of the parent unit screen.
	Pairing baby unit <ul style="list-style-type: none"> The baby unit and parent unit provided are already paired.
	Unpairing baby unit <ul style="list-style-type: none"> You can remove the paired baby unit.
	LCD screen off timer <ul style="list-style-type: none"> You can set a specific time for the parent unit screen to switch off.
	Temperature <ul style="list-style-type: none"> You can turn on the Temperature alert tone on so that the parent unit beeps whenever the room temperature detected by the baby unit falls outside the desired temperature range.
	Lullaby <ul style="list-style-type: none"> You can select, play, or stop a lullaby.

Parent unit warning icons and messages

	/No link to Camera <ul style="list-style-type: none"> The baby unit is out of range or is turned off.
	/Battery low at Parent Unit <ul style="list-style-type: none"> The battery is empty and needs to be recharged.
	Pairing or unpairing is complete.
	Pairing or unpairing is in progress.
	Pairing or unpairing has failed.
	/Temperature too high or /Temperature too low <ul style="list-style-type: none"> The temperature detected by the baby unit is higher/lower than the desired temperature alert range.
	The baby unit is unpairing from the parent unit.
	The parent unit is searching for baby unit.

Using the baby monitor

Power the baby unit on or off

- Slide the **ON/OFF** switch up to turn the baby unit on. The **ON/OFF** LED light turns on.
- Slide the **ON/OFF** switch down to turn the baby unit off. The **ON/OFF** LED light turns off.

Power the parent unit on or off

- Press and hold** **⏻** to turn the parent unit on. The screen turns on.
- Press and hold** **⏻** again to turn the parent unit off. The screen turns off.

Turn the parent unit screen on or off

You can turn the parent unit screen on or off without switching the parent unit off. You can still hear sound from the baby unit.

- Press **LCD ON/OFF** on the parent unit to turn the screen off.
- Press any key on the parent unit to turn the screen on again.

Adjust speaker volume

For parent unit:

- Press **VOL+ /VOL-** on the parent unit to adjust the speaker volume.

NOTE

- When the parent unit speaker volume is set to zero, **🔇** appears on the screen and the **🔇** light turns on.

For baby unit:

The baby unit speaker volume determines the talkback volume transmitted from your parent unit.

- Press **+ /VOLUME-** on the baby unit to adjust the speaker volume.

Adjust LCD brightness

You can change the brightness of the parent unit screen from **Level 1** to **Level 5**. The LCD brightness is preset to **Level 3**.

- Press **MENU** when the parent unit is idle.
- Press **◀** or **▶** to choose **☀**, then press **▲**.
- Press **▼** or **▲** to choose the desired level of brightness, then press **SELECT** to confirm your selection.

Zoom

You can zoom in while viewing images from the baby unit.

- Press **Q** to zoom in.
- Press **▼** or **▲** to move the zoomed image up or down.
- Press **◀** or **▶** to move the zoomed image left or right.
- Press **Q** again to zoom out.

Talk

You can use the **TALK** function on the parent unit to comfort your baby.

- Press and hold TALK** on the parent unit. The **TALK** light turns on.
- Speak towards the microphone on the parent unit. Your voice is broadcast to the baby unit.
- Release the **TALK** key to stop the broadcast. The **TALK** light goes off.

NOTE

- When the parent unit speaker volume is set to zero, **🔇** appears on the screen and the **🔇** light turns on.

Lullaby

You can play the lullabies on the baby unit from the parent unit. On the baby unit, you can control the volume level of the lullabies.

Playing lullabies

- Press **MENU** when the parent unit is idle.
- Press **◀** or **▶** to choose **🎵**, then press **▲**.
- Press **▼** or **▲** to choose a lullaby, or choose **🔇** to stop playing.
- Press **SELECT** to confirm your selection.

Volume level control on baby unit

- Press **VOL+** to increase the volume level of the lullaby on the baby unit.
- Press **VOL-** to decrease the volume level of the lullaby on the baby unit.

NOTE

- The lullaby will stop when you start using the **TALK** function on the parent unit to comfort your baby.

Monitor the temperature

Your baby unit monitors the temperature of your baby’s room with its built-in temperature sensor. If the detected temperature is out of the preset temperature range, the parent unit will display an alert message.

Set temperature range

You can set the desired room temperature alert range. The minimum temperature can be set between **50 °F (10 °C)** and **76 °F (24 °C)**. The maximum temperature can be set between **77 °F (25 °C)** and **102 °F (39 °C)**.

- Press **MENU** when the parent unit is idle.
- Press **◀** or **▶** to choose **🌡**, then press **▲**.
- Press **▼** or **▲** to choose **👉**, then press **SELECT**.
- Press **▼** or **▲** to choose **🔊** or **🔇**, then press **SELECT**.
- Press **▼** or **▲** to choose the desired minimum or maximum temperature, then press **SELECT** to confirm your selection.

Temperature alert tone

You can turn the temperature alert tone on so that the parent unit will emit an alert tone if the detected temperature is out of range.

- Press **MENU** when the parent unit is idle.
- Press **◀** or **▶** to choose **🌡**, then press **▲**.
- Press **▼** or **▲** to choose **🔊**, then press **SELECT**.
- Press **▼** or **▲** to choose **🔊** or **🔇**, then press **SELECT** to confirm your selection.

Temperature format

You can choose to display the temperature in Fahrenheit (°F) or Celsius (°C).

- Press **MENU** when the parent unit is idle.
- Press **◀** or **▶** to choose **🌡**, then press **▲**.
- Press **▼** or **▲** to choose **🇺🇸**, then press **SELECT**.
- Press **▼** or **▲** to choose **🇬🇧** or **🇨🇪**, then press **SELECT** to confirm your selection.

General product care

To keep this product working well and looking good, follow these guidelines:

- Avoid putting it near heating appliances and devices that generate electrical noise (for example, motors or fluorescent lamps).
- DO NOT expose it to direct sunlight or moisture.
- Avoid dropping the product or treating it roughly.
- Clean with a soft cloth.
- DO NOT immerse the parent unit and the baby unit in water and do not clean them under the tap.
- DO NOT use cleaning spray or liquid cleaners.
- Make sure the baby unit and parent unit are dry before you connect them to the mains again.

Storage

When you are not going to use the baby monitor for some time, remove the rechargeable battery from the parent unit. Store the parent unit, the baby unit and the adaptors in a cool and dry place.

Frequently asked questions

Below are the questions most frequently asked about the baby monitor. If you cannot find the answer to your question, visit our website at **www.vtech.co.uk**, or contact **01235 546810** for customer service.

Why does the baby monitor not respond normally?	Try the following (in the order listed) for a common cure: <ol style="list-style-type: none">Disconnect the power to the baby unit and the parent unit. Remove the batteries in the parent unit. Then install the batteries again. Wait a few seconds before connecting power back to the baby unit and the parent unit. Turn the baby units and the parent unit on. Wait for the parent unit to synchronise with the baby unit. Allow up to one minute for this to take place.
Why does the parent unit beep?	The baby unit may be out of range. Move the parent unit closer to the baby unit (but not less than 3 feet). <p>If the parent unit is powered by the provided battery, it may not have enough charge for the parent unit to perform normally. Charge the battery in the parent unit for up to 11 hours.</p> <p>The temperature of your baby’s room may be too high or too low.</p>
Why doesn't my parent unit charge while connected to AC power?	Make sure the battery is installed. <p>You may have used the battery for a long time. Replace with a new battery.</p>
Why is my screen in black and white?	The screen is in black and white during night-time or in a dark room when the night vision feature is activated. This is normal due to external light sources.
Why do I get glare or a blurry display on my screen when viewing my baby at night?	During night-time or in a dark room, the surroundings and other interfering factors, like lights, objects, colours and backgrounds may affect the image quality on your parent unit screen. Adjust the baby unit’s angle or place the baby unit at a higher level to prevent glare and a blurry display.
Why does the baby monitor produce a high-pitched noise?	The parent unit and baby unit may be too close to each other. <ul style="list-style-type: none">Move the parent unit away from the baby unit until the noise stops; OR Turn down the volume of your parent unit.

- Never push objects of any kind into this product through the slots because they may touch dangerous voltage points or create a short circuit. Never spill liquid of any kind on the product.
- To reduce the risk of electric shock, do not disassemble this product, but take it to an authorised service facility. Opening or removing parts of the product other than specified access doors may expose you to dangerous voltages or other risks. Incorrect reassembling can cause electric shock when the product is subsequently used.
- You should test the sound reception every time you turn on the units or move one of the components.
- Periodically examine all components for damage.
- Be aware of possible loss of privacy while using public airwaves. Conversations may be picked up by other nursery monitors, cordless phones, scanners, etc.
- Children should be supervised to ensure that they do not play with the product.
- The product is not intended for use by persons (including children) with reduced physical, sensory or mental capabilities, or lack of experience and knowledge, unless they have been given supervision or instruction concerning use of the appliance by a person responsible for their safety.

SAVE THESE INSTRUCTIONS

Cautions

- Use and store the product at a temperature between 0°C and 40°C.
- Do not expose the product to extreme cold, heat or direct sunlight. Do not put the product close to a heating source.
- Batteries should not be exposed to excessive heat such as bright sunshine or fire.
- ⚠Warning—**Strangulation Hazard— Keep this cord out of the reach of children (more than 3 ft (0.9 m) away). Do not remove this tag. 
- Never place the baby unit inside the baby’s cot or playpen. Never cover the baby unit or parent unit with anything such as a towel or a blanket.
- Other electronic products may cause interference with your baby monitor. Try installing your baby monitor as far away from these electronic devices as possible: wireless routers, radios, mobile telephones, intercoms, room monitors, televisions, personal computers, kitchen appliances and cordless telephones.

Customer service and product warranty

IMPORTANT

Please retain this booklet with your sales receipt as proof of the date of purchase.

Customer Service

Please call our Consumer Services Department on 01235 546810 (from UK) or +44 1235 546810 (outside UK) and a service representative will be happy to help you.



PRODUCT REGISTRATION

Visit www.vtech.co.uk/clubvtech/login to register your VTech product

By joining the VTech Club you can also enter competitions, find out about news and events, seek expert advice for parents and let your kids play fun learning games and activities.

	PRODUCT WARRANTY
	Thank you for choosing this quality product from VTech. We hope it will bring many hours of entertainment, imaginative play and learning.
	<small>1. The product detailed above is covered by a one year warranty from the date of purchase, against any defects in materials or workmanship.</small>
	<small>2. The product may be returned to the place of purchase. Alternatively the product can be returned to VTech Electronics Europe plc (see address below), with proof of purchase, without proof of purchase no replacement will be provided.</small>
	<small>3. VTech Electronics Europe plc will examine the product and if it is found to be defective due to faulty materials or workmanship, will replace the product at their discretion.</small>
	<small>4. If the product covered by this warranty is damaged due to misuse, modification or unauthorised repair, or because of faulty batteries, battery discharge or incorrect electrical connections, then this warranty becomes void.</small>
	<small>5. This warranty is personal to the original purchaser and is not transferable.</small>
	<small>6. Breakages to the LCD screen are not covered by the warranty.</small>
	<small>7. Returns to VTech Electronics Europe plc should include a cheque or postal order for £1.50 towards the cost of return postage and packaging.</small>
	<small>8. Products returned to VTech Electronics Europe plc, should be addressed as follows and packed carefully to avoid damage in transit (Please do not include batteries or adaptor). Please include details of the fault together with your name and address.</small>
	<small>9. To keep an online record of your warranty, please register your product online at www.vtech.co.uk/warranty</small>
	<small>Vtech Electronics EU PLC, c/o XPO Logistics, Warehouse 350, Cat & Fiddle Lane, West Hallam, DE7 6HE</small>
	<small>THIS WARRANTY IS OFFERED AS AN EXTRA BENEFIT AND DOES NOT AFFECT CONSUMERS' STATUTORY RIGHTS.</small>
	<small>This warranty is valid for the UK and Eire only. For products purchased outside the UK and Eire, please contact your local distributor or place of purchase.</small>

Technical specifications

Frequency control	Crystal controlled PLL synthesizer
Transmit frequency	Baby unit: 2405 - 2475 MHz <p>Parent unit: 2405 - 2475 MHz</p>
Channels	32
Maximum RF power	20dBm
LCD	2.8" Colour LCD (WQVGA 320x240 pixel)
Nominal effective range	Actual operating range may vary according to environmental conditions at the time of use.
Power requirements	Parent unit: 3.6V Ni-MH battery <p>Baby unit power adaptor: Output: 6V DC @ 500mA</p> <p>Parent unit power adaptor: Output: 6V DC @ 500mA</p>

Disposal of batteries and product



The crossed-out wheellie bin symbols on products and batteries, or on their respective packaging, indicates they must not be disposed of in domestic waste as they contain substances that can be damaging to the environment and human health.



The chemical symbols Hg, Cd or Pb, where marked, indicate that the battery contains more than the specified value of mercury (Hg), cadmium (Cd) or lead (Pn) set out in Battery Directive (2006/66/EC).

The solid bar indicates that the product was placed on the market after 13th August, 2005.

Help protect the environment by disposing of your product or batteries responsibly.

Why don't the power-on lights on the baby unit or the parent unit go on when I switch the units on?	Perhaps the parent unit is not connected to the power. Insert the appliance plug into the parent unit and put the adaptor in a wall socket. Then press and hold ⏻ to switch the parent unit on and to establish connection with the baby unit. <p>Perhaps the baby unit is not connected to the power. Insert the appliance plug into the baby unit and put the adaptor in a wall socket. Then slide the ON/OFF switch to ON to switch the baby unit on and to establish connection with the parent unit.</p>
Why doesn't my parent unit charge while connected to AC power?	Make sure the battery is installed. <p>You may have used the battery for a long time. Replace with a new battery.</p>
Why is my screen in black and white?	The screen is in black and white during night-time or in a dark room when the night vision feature is activated. This is normal due to external light sources.
Why do I get glare or a blurry display on my screen when viewing my baby at night?	During night-time or in a dark room, the surroundings and other interfering factors, like lights, objects, colours and backgrounds may affect the image quality on your parent unit screen. Adjust the baby unit’s angle or place the baby unit at a higher level to prevent glare and a blurry display.
Why does the baby monitor produce a high-pitched noise?	The parent unit and baby unit may be too close to each other. <ul style="list-style-type: none">Move the parent unit away from the baby unit until the noise stops; OR Turn down the volume of your parent unit.
Why does the parent unit beep?	The baby unit may be out of range. Move the parent unit closer to the baby unit (but not less than 3 feet). <p>If the parent unit is powered by the provided battery, it may not have enough charge for the parent unit to perform normally. Charge the battery in the parent unit for up to 11 hours.</p> <p>The temperature of your baby’s room may be too high or too low.</p>

The ON/OFF light on the baby unit flashes and the parent unit displays 🔇 .	Follow below steps to pair the baby unit. Make sure both parent unit and baby unit are on before pairing. <ol style="list-style-type: none">Press MENU when the parent unit is idle. Press ◀ or ▶ to choose 👤, then press ▲ to select. Press ▼ or ▲ to choose an empty baby unit slot, then press SELECT. The parent unit screen displays 👤. Use a narrow-pointed object, such as a pen, to press PAIR on the bottom of the baby unit. <ul style="list-style-type: none">The ON/OFF LED light at the side of baby unit flashes quickly when pairing. <p>When pairing is successful, the parent unit screen displays 👤 and the LINK light turns on. The view of the newly paired baby unit will be shown on the parent unit. The ON/OFF LED light on the baby unit remains on.</p> <ul style="list-style-type: none">If pairing fails, the screen displays ⚠. Try the pairing process again.
I have accidentally unpaired my baby unit.	The parent unit speaker volume may be too low or off. Press VOL+ to increase the volume.
Why don't I hear a sound/Why can't I hear my baby cry?	The baby unit may be out of range. Move the parent unit closer to the baby unit (but not less than 3 feet).
Why can't I establish a connection? Why is the connection lost every now and then? Why are there sound interruptions?	Other electronic products may cause interference with your baby monitor. Try installing your baby monitor as far away from these electronic devices as possible.

Important safety instructions

When using your equipment, basic safety precautions should always be followed to reduce the risk of fire, electric shock and injury, including the following:

- Follow all warnings and instructions marked on the product.
- Adult setup is required.
- This product is intended as an aid. It is not a substitute for responsible and proper adult supervision and should not be used as such.
- This product is not intended for use as a medical monitor.
- Do not use this product near water. For example, do not use it next to a bath tub, wash bowl, kitchen sink, laundry tub or swimming pool, or in a wet basement or shower.
- CAUTION:** Use only the batteries indicated in this manual. There may be a risk of explosion if a wrong type of battery is used for the parent unit. Use only the supplied rechargeable battery for the parent unit. Do not dispose of batteries in a fire. They may explode. Dispose of used battery according to the information in The RBRC® seal.
- Use only the adaptors included with this product. Incorrect adaptor polarity or voltage can seriously damage the product. Baby unit power adaptor: Output: 6V DC 500mA Parent unit power adaptor: Output: 6V DC 500mA.
- The power adaptors are intended to be correctly oriented in a vertical or floor mount position. The prongs are not designed to hold the plug in place if it is plugged into a ceiling, under-the-table or cabinet outlet.
- Unplug this product from the wall outlet before cleaning. Do not use liquid or aerosol cleaners. Use a damp cloth for cleaning.
- Unplug the power cords before replacing batteries.
- Do not cut off the power adaptors to replace them with other plugs, as this causes a hazardous situation.
- Do not allow anything to rest on the power cords. Do not install this product where the cords may be walked on or crimped.
- This product should be operated only from the type of power source indicated on the marking label. If you are not sure of the type of power supply in your home, consult your dealer or local power company.
- Do not overload wall outlets or use an extension cord.
- Do not place this product on an unstable table, shelf, stand or other unstable surfaces.
- This product should not be placed in any area where proper ventilation is not provided. Slots and openings in the back or bottom of this product are provided for ventilation. To protect them from overheating, these openings must not be blocked by placing the product on a soft surface such as a bed, sofa or rug. This product should never be placed near or over a radiator or heat register.

